

## 2.5" SKIMMER CUT SHEET

Ships in cardboard box | Dimensions: 30" x 24" x 9"

Patent # 5,820,751

# Faircloth Skimmer®

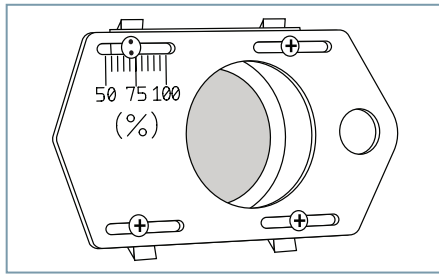

### ADJUSTABLE ORIFICE GATE

Slide the orifice gate until the dots on the indicator screw match the opening percentage in the plans. Then tighten the three Phillips screws.

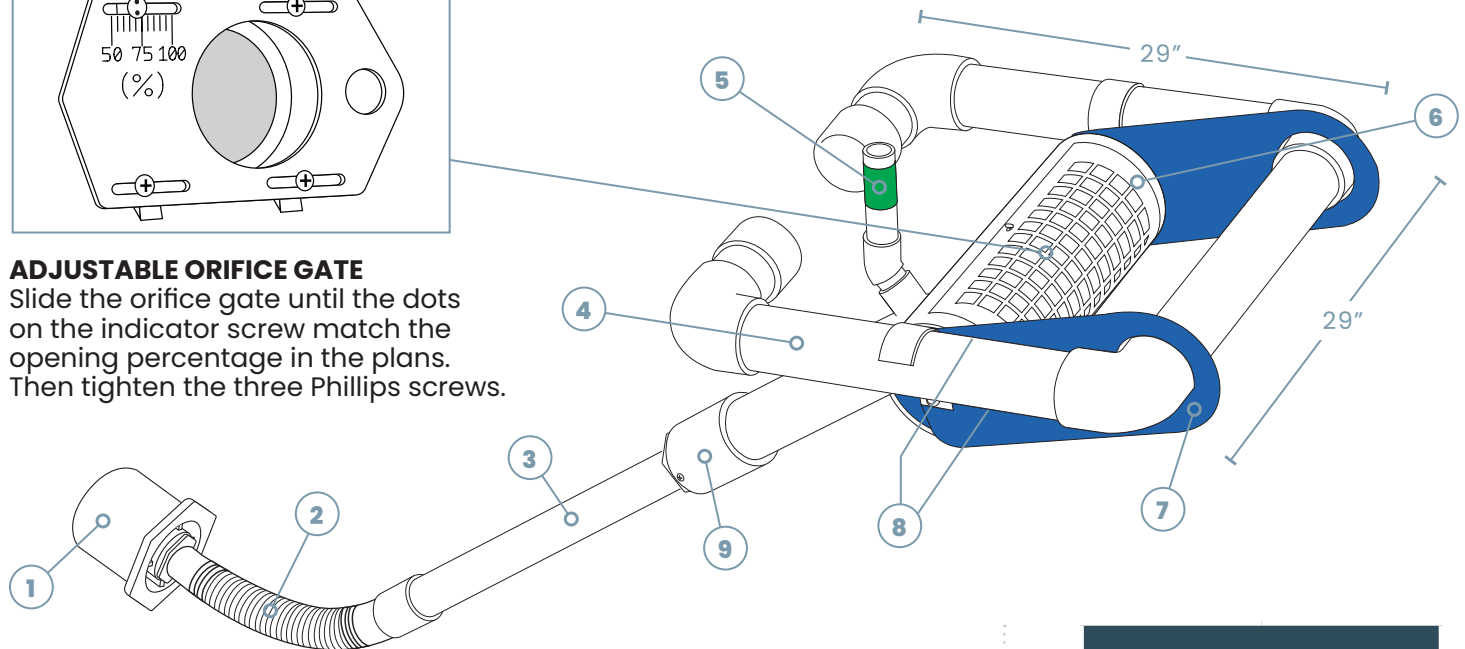

\* Skimmer shown in floating position

- 1 4" Sch 40 coupling connection to be attached to a 4" outlet structure.
- 2 1½" Flex hose with 1½" female coupling to be connected to barrel pipe.
- 3 1½" Sch 40 solid PVC barrel (SUPPLIED BY USER). Barrel kit can be purchased separately.
- 4 2½" PVC float.
- 5 1½" Vent with GREEN tip.
- 6 Inlet assembly with aluminum screen that houses 2.5" adjustable orifice gate.
- 7 1/8" inch HDPE blue skirts.
- 8 2½" Head (distance from center of inlet to water surface).
- 9 2½" Inlet extension.

### PRE-ASSEMBLED FLEX HOSE ASSEMBLY

### Additional Parts Included

12" of  
4" Pipe



Can be added to 4" coupling to assist in attaching to outlet structure.

50'  
Rope



Attach to skimmer so that it can be pulled to the side of the sediment basin for maintenance.

### Non-Included Parts

1½" Sch 40 SOLID  
PVC barrel or "arm"  
(See #3)

**SHIPS ASSEMBLED. USER INSTALLS COMPONENTS AND SETS ORIFICE GATE TO ENGINEER SPECIFIED OPENING PERCENTAGE.**

For technical data, sizing, cut sheets, or design assistance please contact us at:

**(919) 732-1244** or visit **fairclothskimmer.com**



**Bowman**  
Construction  
Supply Inc.



**Quick**  
Supply Co.



**Cascade**  
GEOSYNTHETICS

## LOCATIONS & CONTACT INFO

### ASP ENTERPRISES

aspent.com  
salesasp@aspent.com

### BOWMAN CONSTRUCTION SUPPLY

bowmanconstructionsupply.com  
salesbcs@bowmanconstructionsupply.com

### QUICK SUPPLY CO.

quicksupplyco.com  
salesquick@quicksupplyco.com

### CASCADE GEOSYNTHETICS

cascadegeos.com  
salescascade@cascadegeos.com

**St. Louis, MO** 636.343.4357  
**Omaha, NE** 402.861.8579  
**Kansas City, MO** 816.554.1191  
**Wichita, KS** 316.393.1554

**Denver, CO** 303.696.8960  
**Colorado Springs, CO** 719.257.7840  
**Loveland, CO** 970.535.0863

**Des Moines, IA**  
515.289.1271

**Portland, OR**  
971.339.1020

## SOLUTIONS WE SUPPLY

### GEOSYNTHETICS

Filter Fabrics

Stabilization Fabrics

Geogrids

- Road Grids
- Wall Grids
- Slope Stabilization

Specialty Fabrics

Composite Geomembranes

- GCLs, PVC, HDPE, LLDPE, EPDM, Granular Bentonite

### SEDIMENT CONTROL

Inlet Protection

- Grated Inlet, Curb Inlet, Area Inlet Protection

Ditch Checks

- Triangle Silt Dike
- GeoRidge

Perimeter Protection

- High and Low-Porosity Silt Fence, Straw Wattles, Silt Socks
- Safety Fence

Flocculants & Water Treatment

- Polymer-Based & Natural Flocculants

Sediment Basin Skimmers

Dewatering Bags

Trackout Control

- FODS
- Rumble Grates

Turbidity Curtains

### EROSION CONTROL

Basic Hydraulically Applied Mulches

- Wood
- Paper
- Blends
- Straw

High-Performance Hydraulically

Applied Products

- BFM
- FGM
- Additives & Tackifiers

Temporary Erosion Control Blankets

- Coir & Jute Mat/Nettings
- Short-Term ECBs
- Extended-Term ECBs

Permanent Erosion Control Blankets

- Turf Reinforcement Mats
- HP-TRMs
- Anchor Reinforced Vegetation System

Structural BMPs

- Transition Mats
- Geoweb Cellular Confinement
- Composite Vegetated Armor System
- Flex MSE Vegetated Wall System
- Articulated Concrete Block
- Gabions
- Grout-Filled Geotextile Mats

Vegetation Establishment

- Native Seed & Turf Seed
- Fertilizers
- Organic Soil Additives
- Stratavault Soil Cells

### STORMWATER MANAGEMENT

Water Quality

- Inlet Filter Boxes
- Pre-Treatment Chamber
- Nutrient Separating Baffle Boxes
- High-Flow Biofiltration Media
- Hydrodynamic Separators
- Stratavault

Water Quantity

- Modular Underground Storage Systems
- Chamber Detention Systems

Drainage

- HDPE Swale Liner
- Pipe & Fittings
- Drainage Composites
- Strip Drain

Inlet Structures

- PVC
- Drain Basins, In-Line Drains
- Landscape

Permeable Pavers

- Permeable Articulating Concrete Block
- Grass Pavers
- Gravel Pavers
- Concrete Pavers

### SPECIALTY

Natural & Synthetic Coir Fiber Logs

Vegetated Reinforced Soil Slopes

Soil Anchors

Root Barrier System

AquaBlok

Muscle Wall

We are full line distributors of construction materials for all project types. Contact us for assistance with a project. From specification and development to installation and completion, we're here to help with all of your site solution needs.

**GEOSYNTHETICS | EROSION CONTROL | STORMWATER MANAGEMENT**  
**SEDIMENT CONTROL | REVEGETATION & SOIL AMENDMENTS**